



1 Dartford Street

London, SE17 3UQ

£1,500 Per Month

A fantastic period conversion flat situated in an ideal location for transport and shopping amenities. The flat has bundles of space throughout and direct access to a courtyard garden. The property is ideally suited for a couple or single occupant.

Southwark Council Tax Band A £1195.00

Total deposit £1846.15 (5 weeks rent)

Viewing

Please contact our Galloways West Norwood Office on 020 8766 6111

if you wish to arrange a viewing appointment for this property or require further information

- TWO DOUBLE BEDROOMS
- HIGH CEILINGS
- COURTYARD GARDEN
- DOUBLE GLAZING
- CENTRAL HEATING
- FITTED KITCHEN AND BATHROOM
- 0.2 MILES TO BURGESS PARK
- 0.7 MILES TO KENNIGINTON TUBE
- 0.8 MILES TO ELEPHANT & CASTLE
- (TIMES ESTIMATED VIA GOOGLE MAPS)

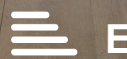

Floor Plan

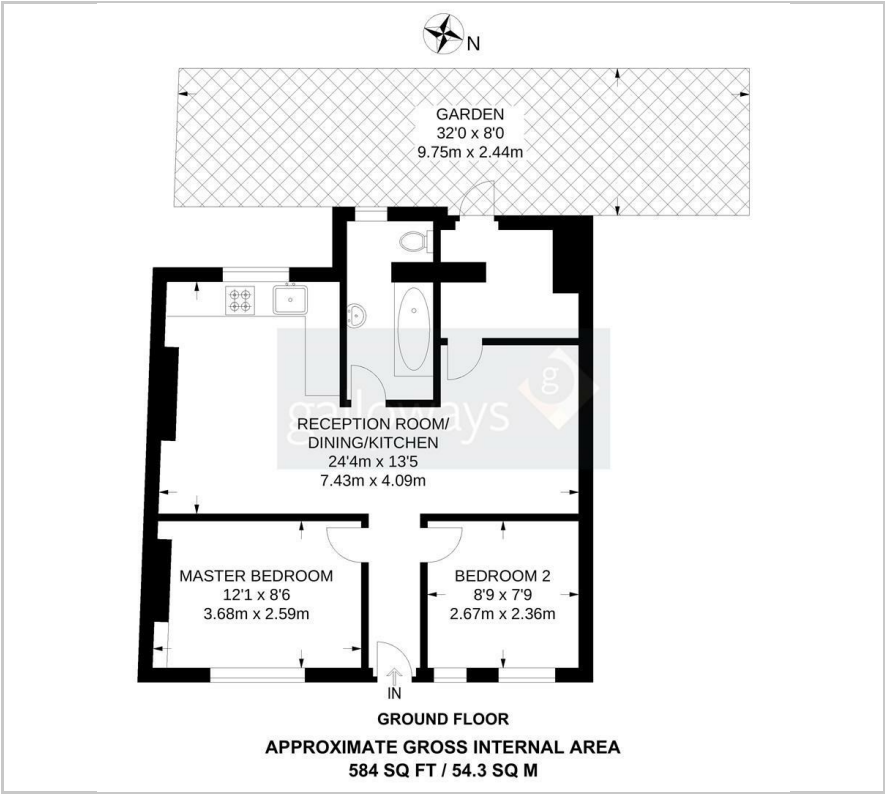

Area Map



Energy Efficiency Graph

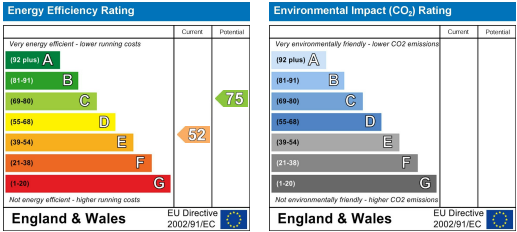

These particulars, whilst believed to be accurate are set out as a general outline only for guidance and do not constitute any part of an offer or contract. Intending purchasers should not rely on them as statements of representation of fact, but must satisfy themselves by inspection or otherwise as to their accuracy. No person in this firms employment has the authority to make or give any representation or warranty in respect of the property.